

Product-Number	COMMENT
72812-002LF	RoHS COMPATIBLE VERSION

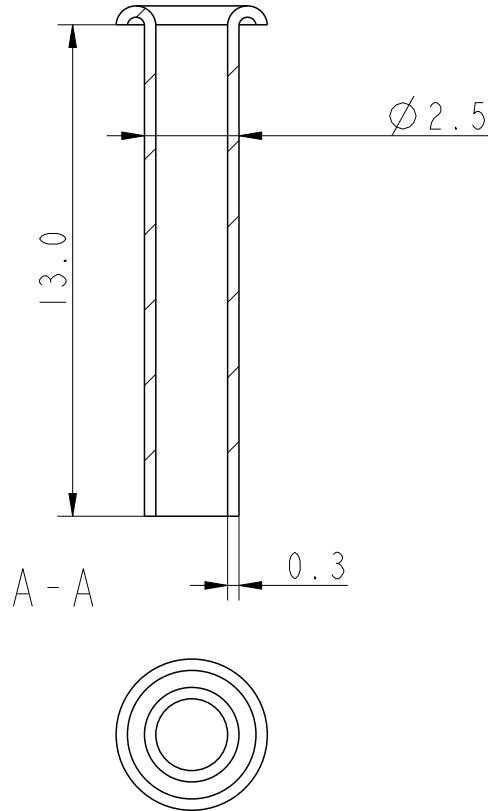

NOTE: RoHS INFORMATIONS

- The "LF" product meets European union Directives and other country regulations as described in GS-22-008.
- The product is not intended to be exposed to a manufacturing solder process.
- Packaging spec: see GS-14-920.

Surface coating over all:
Chemical tinning Sn 0.5 µm.

rev	ecn no	dr	date
A	SW0100	TAn	000928
B	LS05-0086	JTA	30/09/05
C	LS08-209	JTA	2008/10/28
-	-	-	-
-	-	-	-
-	-	-	-
-	-	-	-

www.fciconnect.com

surface	tolerance std	projection	mm
ISO 1302 ✓	ISO 406 ISO 1101		
TOLERANCES UNLESS OTHERWISE SPECIFIED			Scale 5:1
Dr	T. Andersson	000928	
Eng	J. Jacobson	000928	size A4
Chr	H. Carneling	000928	ECN LS08-0209
Appr	J. Jacobson	000928	Spec ref

	title	TUBULAR RIVET	dwg no	72812C	Rev.	C
	catalog no		CUSTOMER	sheet 1 of 1		

REV F - 2006-04-17



Copyright FCI.